



Portable Tattoo Printer

User Manual



EMALLA
DESIGNED BY MAKE TATTOOING SAFE

1. Product Introduction

1.1 Packing List

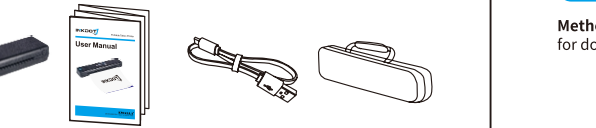

Printer×1 Quick Start Guide×1 Type-C Cable×1 Velvet Pouch×1

1.2 Printer Parts Instruction

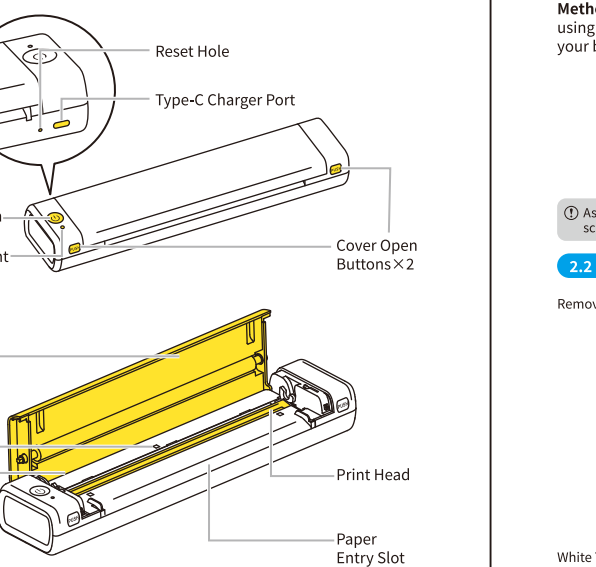

2. Getting Started

2.1 Downloading the App

Method 1: Search for the "ePrinter" app on App Store® or Google Play™ for download and installation.



Method 2: Scan the QR code to download the app. You can scan the code using your cell phone's camera, the built-in QR code scanning feature of your browser, or a dedicated QR code scanning app.



ⓘ As the Safari browser on Apple devices does not support direct QR code scanning, please use your device's built-in QR code scanner instead.

2.2 Tattoo Transfer Paper Introduction

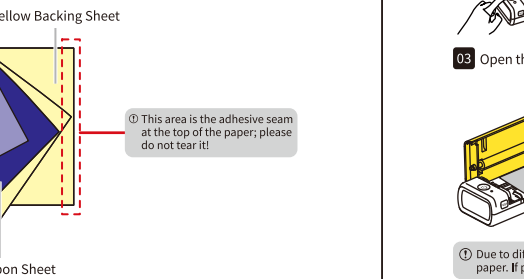

2.3 Preparation Before Use

01 Take out a piece of tattoo transfer paper, and remove its Protective Sheet.

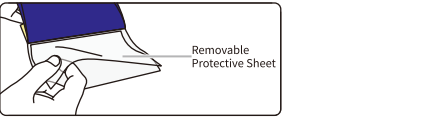

02 Trim the Yellow Backing Sheet along the top adhesive seam with a ruler or scissors.

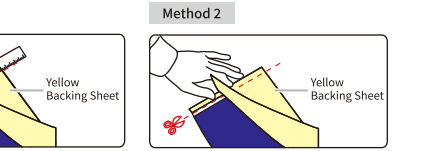

ⓘ When cutting, please make sure that the adhesive area remains intact.

2.4 Paper Installation Guide

01 Long press the Power Button for 3 seconds until the Indicator Light is green to power up the printer.

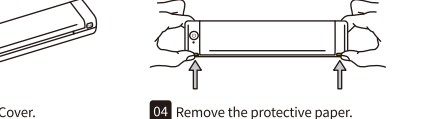

02 Simultaneously press the Cover Open Buttons with both hands.

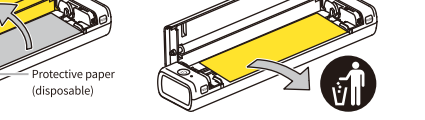

03 Open the Top Cover.



04 Put the Top Cover back down, and press down on both of its ends at the same time until you hear a click, indicating the cover is securely closed.



05 Place the white tracing paper face up and flat into the printer in the direction of the paper outlet. Make sure the tattoo paper covers the sensor.



06 Trim the Yellow Backing Sheet along the top adhesive seam with a ruler or scissors.



07 Select the image to print.

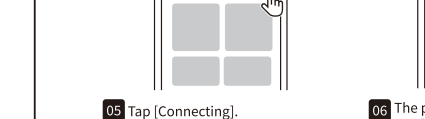

08 Edit your first image, and tap [Done] after you finish editing.

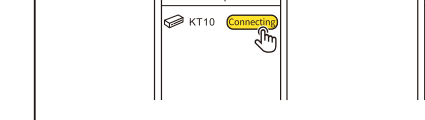

09 Confirm the preview of the image, and tap [Print].

10 Printing is completed.



11 Retrieve the printout.

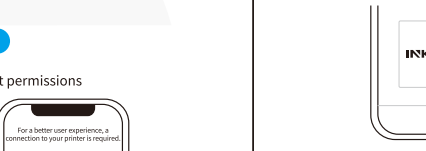

12 Tear off the White Tracing Sheet for use.

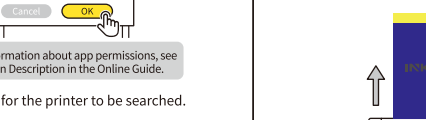

2.5 User Guide: Printing via Mobile App

01 Open the "ePrinter" app.



02 Grant permissions.

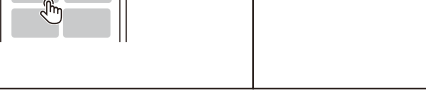

ⓘ For a better user experience, a connection to your printer is required.

ⓘ The file formats supported by the printer include JPG, PNG, etc.

ⓘ For more information about app permissions, see 5.3 Permission Description in the Online Guide.

03 Tap [Done] at the top right corner.

04 Wait for the printer to be searched.

05 Tap [Connecting].

06 The printer is connected. Tap [Tattoo editing].

ⓘ Due to differences in printer versions, some printers may not include disposable protective paper. If protective paper is not available, skip this step.

07 Connect the printer to the computer using the original Type-C cable supplied with the printer.

08 Retrieve the printout. Tear off the White Tracing Sheet for use.

09 Select the image to print.

10 Edit your first image, and tap [Done] after you finish editing.

11 Confirm the preview of the image, and tap [Print].

12 Printing is completed.

13 Select and open the file you need to print.

14 Tap [Print].

15 Select the KT10 Printer, and click [Print] to start printing.

16 Retrieve the printout. Tear off the White Tracing Sheet for use.

17 Select the image to print.

18 Edit your first image, and tap [Done] after you finish editing.

19 Confirm the preview of the image, and tap [Print].

20 Printing is completed.

21 Select and open the file you need to print.

22 Tap [Print].

23 Select the KT10 Printer, and click [Print] to start printing.

24 Retrieve the printout. Tear off the White Tracing Sheet for use.

25 Select the image to print.

26 Edit your first image, and tap [Done] after you finish editing.

27 Confirm the preview of the image, and tap [Print].

28 Printing is completed.

29 Select and open the file you need to print.

30 Tap [Print].

31 Select the KT10 Printer, and click [Print] to start printing.

32 Retrieve the printout. Tear off the White Tracing Sheet for use.

33 Select the image to print.

34 Edit your first image, and tap [Done] after you finish editing.

35 Confirm the preview of the image, and tap [Print].

36 Printing is completed.

37 Select and open the file you need to print.

38 Tap [Print].

39 Select the KT10 Printer, and click [Print] to start printing.

40 Retrieve the printout. Tear off the White Tracing Sheet for use.

41 Select the image to print.

42 Edit your first image, and tap [Done] after you finish editing.

43 Confirm the preview of the image, and tap [Print].

44 Printing is completed.

45 Select and open the file you need to print.

46 Tap [Print].

47 Select the KT10 Printer, and click [Print] to start printing.

48 Retrieve the printout. Tear off the White Tracing Sheet for use.

49 Select the image to print.

50 Edit your first image, and tap [Done] after you finish editing.

51 Confirm the preview of the image, and tap [Print].

52 Printing is completed.

53 Select and open the file you need to print.

54 Tap [Print].

55 Select the KT10 Printer, and click [Print] to start printing.

56 Retrieve the printout. Tear off the White Tracing Sheet for use.

57 Select the image to print.

58 Edit your first image, and tap [Done] after you finish editing.

59 Confirm the preview of the image, and tap [Print].

60 Printing is completed.

61 Select and open the file you need to print.

62 Tap [Print].

63 Select the KT10 Printer, and click [Print] to start printing.

64 Retrieve the printout. Tear off the White Tracing Sheet for use.

65 Select the image to print.

66 Edit your first image, and tap [Done] after you finish editing.

67 Confirm the preview of the image, and tap [Print].

68 Printing is completed.

69 Select and open the file you need to print.

70 Tap [Print].

71 Select the KT10 Printer, and click [Print] to start printing.

72 Retrieve the printout. Tear off the White Tracing Sheet for use.

73 Select the image to print.

74 Edit your first image, and tap [Done] after you finish editing.

75 Confirm the preview of the image, and tap [Print].

76 Printing is completed.

77 Select and open the file you need to print.

78 Tap [Print].

79 Select the KT10 Printer, and click [Print] to start printing.

80 Retrieve the printout. Tear off the White Tracing Sheet for use.

81 Select the image to print.

82 Edit your first image, and tap [Done] after you finish editing.

83 Confirm the preview of the image, and tap [Print].

84 Printing is completed.

85 Select and open the file you need to print.

86 Tap [Print].

87 Select the KT10 Printer, and click [Print] to start printing.

88 Retrieve the printout. Tear off the White Tracing Sheet for use.

89 Select the image to print.

90 Edit your first image, and tap [Done] after you finish editing.

91 Confirm the preview of the image, and tap [Print].

92 Printing is completed.

93 Select and open the file you need to print.

94 Tap [Print].

95 Select the KT10 Printer, and click [Print] to start printing.

96 Retrieve the printout. Tear off the White Tracing Sheet for use.

97 Select the image to print.

98 Edit your first image, and tap [Done] after you finish editing.

99 Confirm the preview of the image, and tap [Print].

100 Printing is completed.

101 Select and open the file you need to print.

102 Tap [Print].

103 Select the KT10 Printer, and click [Print] to start printing.

104 Retrieve the printout. Tear off the White Tracing Sheet for use.

105 Select the image to print.

106 Edit your first image, and tap [Done] after you finish editing.

107 Confirm the preview of the image, and tap [Print].

108 Printing is completed.

109 Select and open the file you need to print.

